

- NOTES**
- THIS DRAWING IS TO BE READ IN CONJUNCTION WITH ALL OTHER RELEVANT ENGINEERING DRAWINGS. ANY DISCREPANCIES, ERRORS OR OMISSIONS TO BE BROUGHT TO THE ATTENTION OF THE EMPLOYER.
 - ALL DIMENSIONS TO BE CHECKED BY THE CONTRACTOR ON SITE PRIOR TO COMMENCEMENT OF WORKS.
 - EMPLOYER'S REPRESENTATIVE TO BE INFORMED BY THE CONTRACTOR OF ANY DISCREPANCIES PRIOR TO THE COMMENCEMENT OF WORKS ON SITE.
 - DIMENSIONS OF ALL BOUNDARIES AND ADJOINING ROADS TO BE CHECKED ON SITE PRIOR TO COMMENCEMENT OF WORKS.
 - DO NOT SCALE. ALL MEASUREMENTS AND COORDINATES TO BE CHECKED ON SITE.
 - EXISTING FENCE LINES ARE INDICATIVE AND ARE TO BE CONFIRMED ON SITE. EXISTING FENCING IS TO BE REVIEWED ON SITE AND REPLACED WHERE REQUIRED.
 - EMERGENCY ACCESS POINTS ARE TO BE CLOSED OFF WITH DEMOUNTABLE BOLLARDS. KEYS TO BE HANDED OVER TO THE OVERSEEING ORGANISATION.
 - EGREENWAY DRAINAGE IS TO BE OVER THE EDGE DRAINAGE.
 - PROPOSED FENCELINE TO BE ERECTED IN ACCORDANCE WITH TII STANDARD DETAIL CC-SCD-00303.

ISSUE/REVISION

I/R	DATE	DESCRIPTION
C	DEC 2023	ABP RFI UPDATE
B	APRIL 2023	ABP RFI UPDATE
A	JUNE 2020	ISSUED FOR INFORMATION

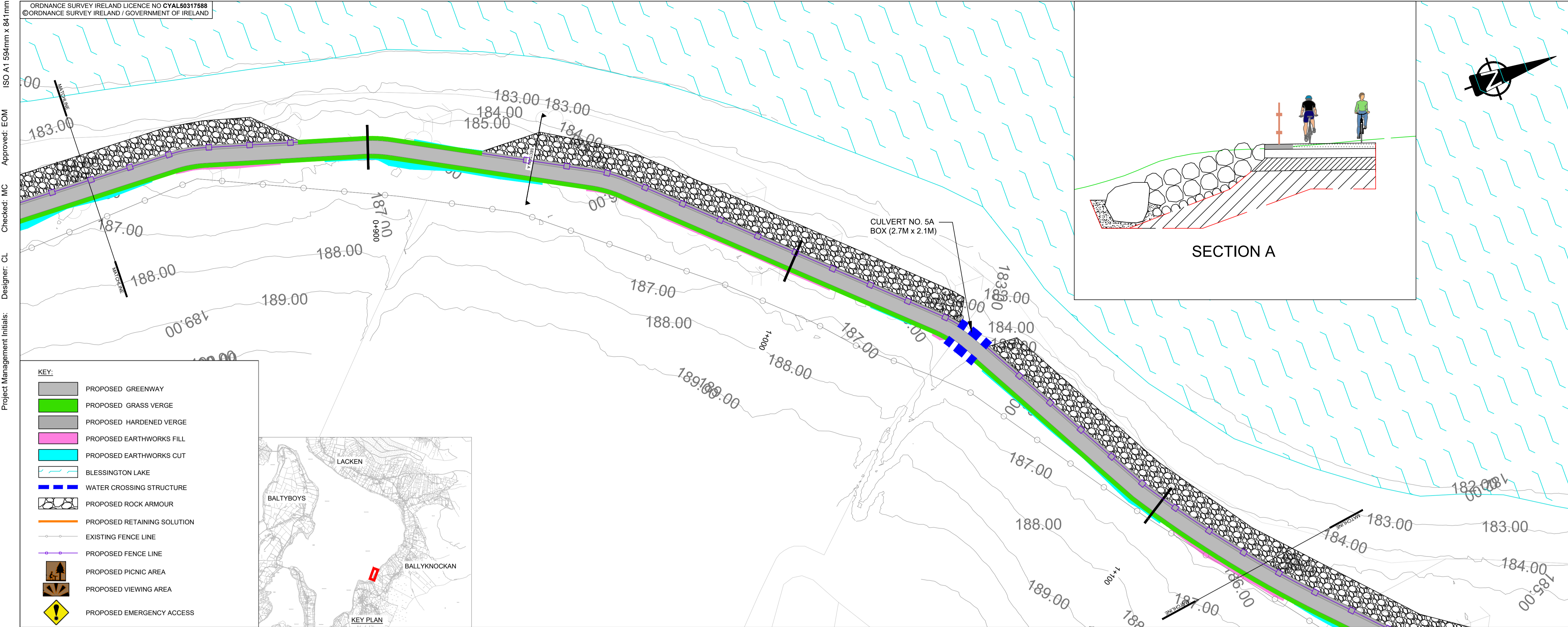

ISO A1 594mm x 841mm
 Approved: EOM
 Checked: MC
 Designer: CL
 Project Management Initials:

KEY:

- PROPOSED GREENWAY
- PROPOSED GRASS VERGE
- PROPOSED HARDENED VERGE
- PROPOSED EARTHWORKS FILL
- PROPOSED EARTHWORKS CUT
- BLESSINGTON LAKE
- WATER CROSSING STRUCTURE
- PROPOSED ROCK ARMOUR
- PROPOSED RETAINING SOLUTION
- EXISTING FENCE LINE
- PROPOSED FENCE LINE
- PROPOSED PICNIC AREA
- PROPOSED VIEWING AREA
- PROPOSED EMERGENCY ACCESS

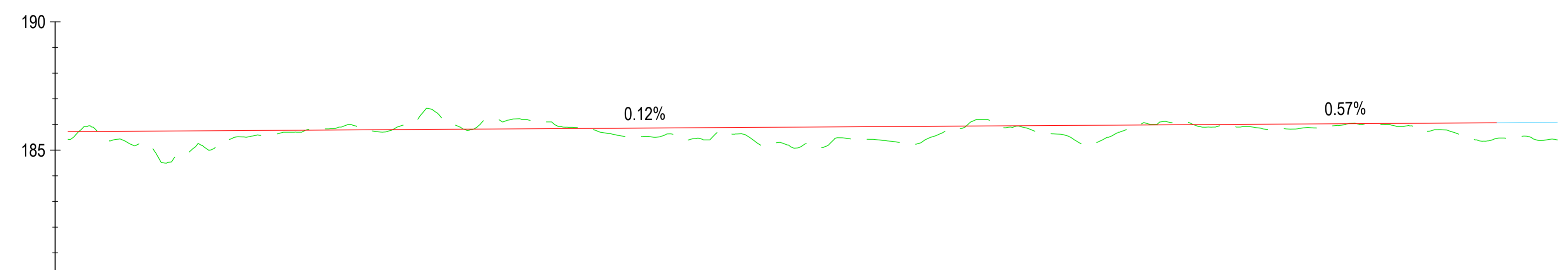
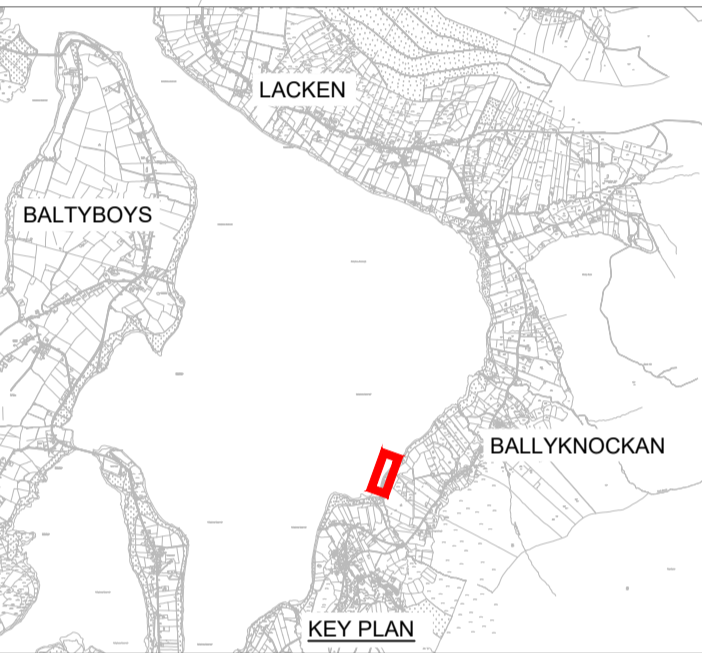

CHAINAGE	840.000	850.000	900.000	950.000	1000.000	1050.000	1100.000	1130.000
EXISTING LEVELS	185.426	185.434	185.724	185.495	185.351	186.044	185.919	185.398
PROPOSED LEVELS	185.722	185.734	185.796	185.858	185.919	185.981	186.043	186.087
VERTICAL ALIGNMENT	G=0.12% 1:809.1					L=44.570 K=100.00		

BALLYKNOCKAN ALIGNMENT (1) LONGSECTION
SCALE: H 1:1000,V 1:200

This drawing has been prepared for the use of AECOM's client. It may not be used, modified, reproduced or relied upon by third parties, except as agreed by AECOM or as required by law. AECOM accepts no responsibility, and denies any liability, whatsoever, to any party that uses or relies on this drawing without AECOM's express written consent. Do not scale this document. All measurements must be obtained from the stated dimensions.